



SVENSK PUMPSTYRNING AB

SÄKER STYRNING

SPS Pump Pit SPS-600B-AV-V1 for Wastewater

“High-quality concrete pump pit with long service life”

Pumpbrunn SPS-600B-AV-A1 is a concrete pump pit equipped with a sewage pump and a brass check valve, designed for pumping wastewater before a treatment plant. It is also equipped with a quick coupling for easier handling and removal of the pump.

Standardhöjd: 2000 totalt (Bottendel 1000+förhöjning 1000mm)

Extensions are available in 200/300/500/1000 mm



Our pump pits are manufactured with high quality and long service life. The pump and pressure pipe are made of stainless steel and feature a convenient quick-coupling system for easy lifting in and out of the pit. Installation is simple thanks to the self-anchoring concrete pump housing.

The pump is controlled by a float level switch.

Optional accessories:

- External wireless alarm.
- SPS-1 control system with start, stop, and alarm. The system is controlled by a sensing tube that detects the water level in the pit. The SPS controller is pre-configured at delivery for quick and easy installation.
- Connection to monitoring landing page

Specifications

- Diameter: 600 mm
- Height: 2000 mm (Base section 1000 mm + extension 1000 mm)
- Alternative extensions available in 200 / 300 / 500 / 1000 mm
- Inlet: Ø 110 mm
- Outlet: Ø PRK 40 or 50 mm
- Cover: Concrete with ventilation
- Telescopic section: No
- Pump: Pedrollo VXM 15/35-N
- Max lifting height: 14 m
- Max flow: 400 L/min
- Voltage: 1 × 230 V
- Output (P2): 1.10 kW
- Rated current: 7.0 A
- Check valve: Yes
- Level control: Float switch
- Alarm: No
- Data monitoring: No

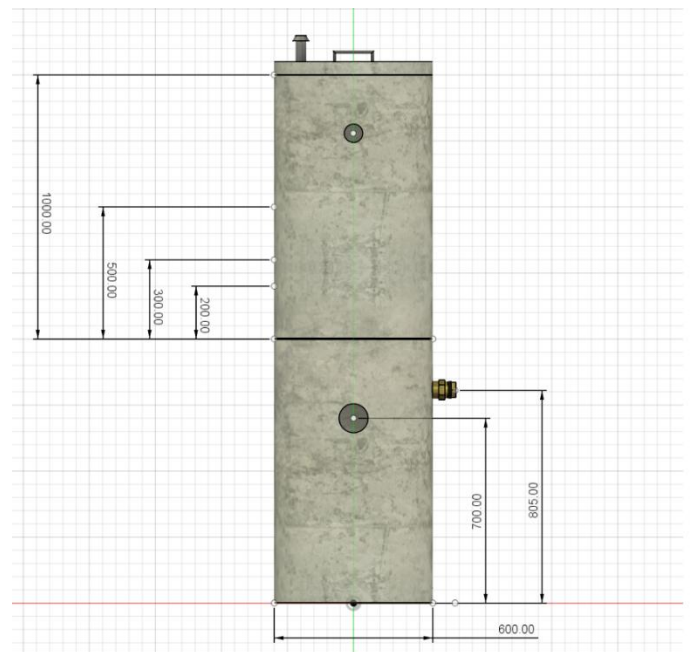

SVENSK PUMPSTYRNING AB

SÄKER STYRNING