

SPS Pump Pit SPS-600B-DRX2 for Greywater, Stormwater, and Drainage Water

*” High-quality concrete pump pit
with long service life”*

The **SPS pump pit SPS-600B-DRX2** is a concrete pump pit equipped with a greywater pump and a brass check valve. It is designed for pumping greywater, stormwater, and drainage water after a treatment plant. It is also fitted with a quick-coupling system to allow easier handling and removal of the pump.



Standard height: 2000 mm total (Base section 1000 mm + extension 1000 mm) Extensions are available in 200 / 300 / 500 / 1000 mm

Our pump pits are built with high quality and long service life. The pump and pressure pipe are made of stainless steel and feature a convenient quick-coupling system for easy lifting in and out of the pit. Installation is simple thanks to the self-anchoring concrete pump housing. The pump is controlled by a vertical float switch.

Optional accessories:

- External wireless alarm.
 - SPS-1 styrsystem with start, stop, and alarm. The system is controlled by a sensing tube that detects the water level in the pit. The SPS control unit is pre-configured at delivery for easy and smooth installation.
 - Connection to monitoring landing page

Specifications

- Diameter: 600 mm
- Height: 2000 mm (Base section 1000+extension 1000mm) Alternative extensions available in 200/300/500/1000 mm
- Inlet: \varnothing 110 mm
- Outlet: PRK 32 alt. PRK 40
- Cover: concrete with ventilation
- Telescopic section: No
- Pump: Pedrollo RXM 2
- Max lifting height: 8 m
- Max flow L/min 190
- Voltage: 1x 230V
- Output P2: 0,37kW
- Rated current: 2,6 A
- Check value: Yes
- Level control: Vertikal float
- Alarm: No
- Weight: 655 kg

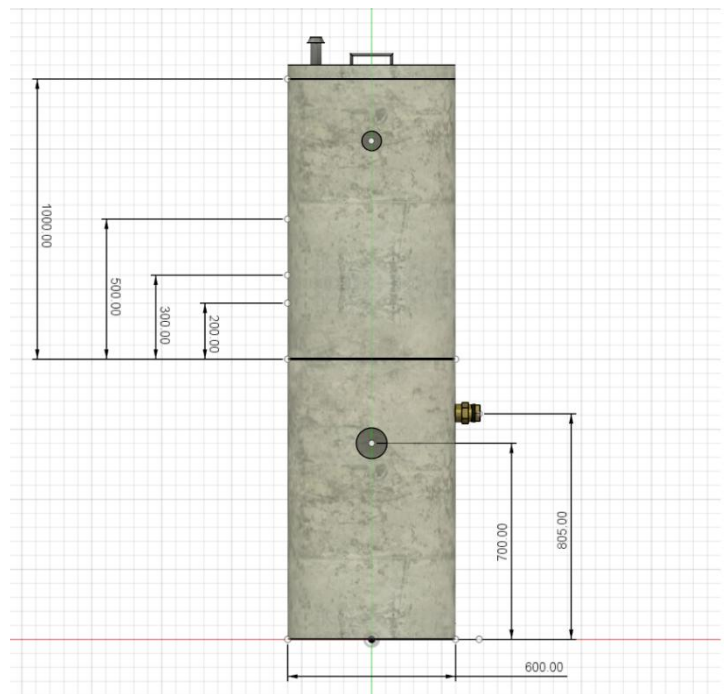

SVENSK PUMPSTYRNING AB
SÄKER STYRNING